

(High Range)

WATER-I.D.[®]
WATER TESTING EQUIPMENT

Ⓓ Giftnotruf-Zentrale München: +49 (0) 89 - 19 240 (24h)
ⒸⒹ Poison Center Munich: +49 (0) 89 - 19 240 (24h)

Water-i.d./Pool-i.d. GmbH
Daimlerstr. 20
D-76344 Eggenstein
Tel. +49 (0) 721 - 782029-0
Fax +49 (0) 721 - 782029-11
www.water-id.com
info@water-id.com



Sulphite No. 1
Sulphite No. 2 **HR**

 Sulphite
 Sulfit
 Sulfite
 Sulfito
 Sulfito
 Sulfito
 Sulfit
 Sulfiet

Tablet-count method

Tabletten-Zählverfahren

Methode de comptage à pilule

Metodo di conteggio de pastiglie

Método Contador de tabletas

Método de contagem de comprimidos

Tablettællings-metoden

Tablet-telmethode

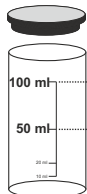

100 ml: 10 - 250 mg/l Na₂SO₃

50 ml: 20 - 500 mg/l Na₂SO₃

Sulphite No. 1

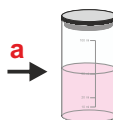
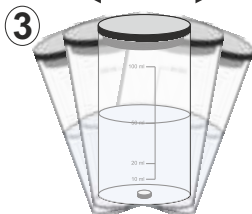
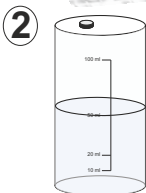
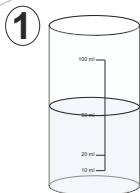

Repeat until

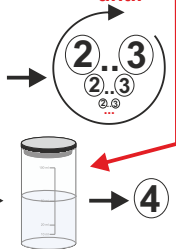

④

④ Sulphite No. 2 HR



⑤

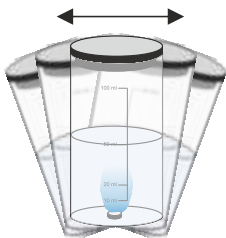

Repeat until

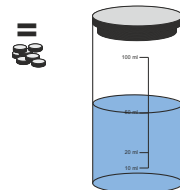

50 ml: (Sulphite No. 2 HR x 40) - 20 = mg/l Na₂SO₃

100 ml: (Sulphite No. 2 HR x 20) - 10 = mg/l Na₂SO₃



QUALITY REAGENTS
MADE IN GERMANY