

Chlorine LR
0.00 - 1.00 mg/l Cl₂



Attention!

Reagents for chemical analyses only! Do not ingest! Keep out of the reach of children! Store in a cool and dry place! Protect from frost! Protect the parameter stick from moisture.



Achtung!

Reagenzien nur für chemische Analysen! Nicht verschlucken! Außerhalb der Reichweite von Kindern aufbewahren! Kühl und trocken lagern! Vor Frost schützen! Den Parameter-Stick vor Feuchtigkeit schützen.



¡Atención!

¡Reactivos sólo para análisis químicos! ¡No ingerir! Manténgase fuera del alcance de los niños. ¡Conservar en lugar fresco y seco! ¡Proteger de las heladas! Proteger el stick de parámetros de la humedad.



Attenzione!

Reagenti solo per analisi chimiche! Non ingerire! Tenere fuori dalla portata dei bambini! Conservare in luogo fresco e asciutto! Proteggere dal gelo! Proteggere lo stick di misurazione dall'umidità.



Attention!

Réactifs uniquement pour les analyses chimiques ! Ne pas ingérer ! Ne doit pas être laissé à la portée des enfants ! Conserver au frais et au sec ! Protéger du gel ! Protéger le stick de paramètres de l'humidité.



Reagents



Reagenzien



Reactivos



Reagenti



Réactifs



FTS100

TbsRD1
DPD No.1 Rapid
(free chlorine)

Optional
TbsRD3
50 x DPD No.3 Rapid
not included in basic kit



1

Fill with 10 ml
water sample

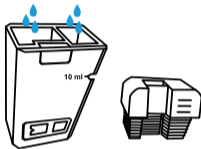

2

1 x DPD No.1 Rapid

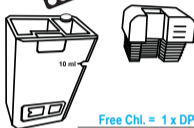

Free Chl. = 1 x DPD 1
Total Chl. = 1 x DPD 1 + 1 x DPD 3
plus 2 min.

Combined Chl. = Total Chl. - Free Chl.

3

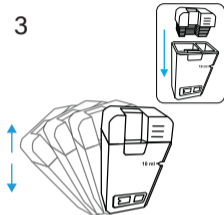

!!! IMPORTANT !!!

Very high levels will bleach out the DPD reagent and lead to colourless solution.

DPD Rapid tablets leave a residue on the bottom of the tester. This is normal and does not interfere with the measurement

4

Insert FTS100
stick

Chlorine
0.00 - 1.00 mg/l Cl₂



5

